

COMMERCIAL



S E R I E S



SSI-25
SSI-24



Mid-America Door Company

STANDARDS

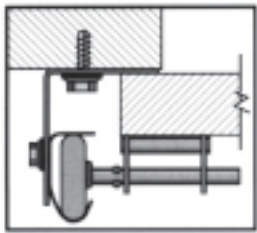

REVERSE ANGLE: Door overlaps jamb approximately 1" against continuous angle of track support system (angle foot toward door). May be used with wood or steel jambs. The door closes against the base flange of the continuous angle.

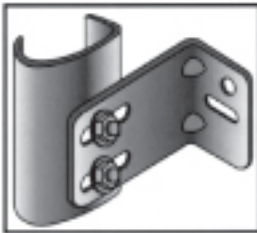

BRACKET MOUNTED TRACK: Use with wood or steel jambs. Door closes against stop molding.

GENERAL: Doors will be SSI Series as manufactured by Mid-America Door Company.

RELATED WORK: Opening preparation, miscellaneous or structural metal work, access panels, finish or field painting, are in the scope of work of other trades.

DOOR SECTIONS: Sections will have a nominal 2" thickness, manufactured using exterior roll formed 25 gauge steel (SSI-25) or 24-gauge steel (SSI-24) and continuous sculpted polystyrene board bonded between the exterior steel face and flush embossed steel interior. Sections will have a tongue and groove meeting rail to provide a weather tight seal between sections. End stiles will be 18 gauge galvanized formed steel. Center stiles will be vertical interior 16 gauge steel plates running the entire section height placed on centers for design requirements. Door sections to have a calculated R factor of 9.4.

TRACK: Galvanized track systems shall be 2" or 3" depending upon door size and will be bracket or angle mounted depending upon application.

HARDWARE: Hinges and brackets to be made from galvanized steel. Each roller shall have ten 1/4" hardened steel balls per roller (2" S-24 Series), or adequate for design requirements.

SPRING COUNTERBALANCE: Springs shall be oil tempered, helical wound and stress relieved torsion type. Springs will be mounted on a continuous cross header steel shaft supported by bearing brackets. Long life springs of 25-50-100 thousand cycles may be specified and are recommended for high usage.

FINISH: Paint will be baked-on commercial white with a polyester coating.

WEATHERSTRIP: Bottom rail of section to include U'd vinyl astragal held in place by retainer to provide additional reinforcement. Additional weatherstripping available for full width of header and jambs.

LOCK: Lock will be interior mounted slide lock. (Optional cylinder lock is available)

VISION SECTIONS: 25 x 5 vinyl frames lites can be provided in either single glaze or double glaze.

OPERATION: Operation to be made by manual lift, chain hoist, or electric motor.

OPTIONAL ENERGY SAVING INSULATION

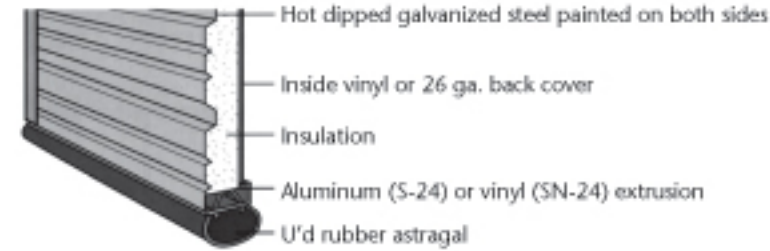

Steel Door Panel and Selection Schedule

| Panels Wide | | Sections High | |
|---------------|---------------|---------------|-----------------|
| Width | No. of Panels | Height | No. of Sections |
| Thru 9'2" | 1 | Thru 8'0" | 4 |
| 9'3" - 12'2" | 2 | 8'3" - 10'0" | 5 |
| 12'3" - 16'2" | 3 | 10'3" - 12'0" | 6 |
| 16'3" - 20'2" | 4 | 12'3" - 14'0" | 7 |
| 20'3" - 24'2" | 5 | 14'3" - 16'0" | 8 |

Clearance and Mounting Requirements

| | Clear Headroom | | Sideroom | | Depth Into Room | Centerline of Springs | |
|------------------------------|------------------|----------|--------------|----------|-----------------------------|-------------------------|-----------------------|
| | 2" Track | 3" Track | 2" Track | 3" Track | 2" & 3" Track | 2" Track | 3" Track |
| Standard Lift Manual 12" | 12 1/2" | 21" | 4 1/2" | 5 1/2" | Door Height + 18" | Door Height + 13 1/2" | Door Height + 15 1/2" |
| Standard Lift Motor Operated | 19" | 22 1/2" | | | | | |
| Standard Lift Manual 15" | 16 1/2" | 21" | 4 1/2" | 5 1/2" | Door Height + 18" | Door Height + 13 1/2" | Door Height + 15 1/2" |
| Standard Lift Motor Operated | 19" | 22 1/2" | | | | | |
| High Lift Manual | Highlift + 12" | | 4 1/2" | 5 1/2" | Door Height Less Lift + 30" | Door Height | Door Height |
| High Lift Motor Operated | Highlift + 12" | | 24" One Side | | Door Height Less Lift + 30" | + Lift + 6 1/2" | + Lift + 7 1/2" |
| Vertical Lift Manual | Door Height + 8" | | 4 1/2" | 5 1/2" | 18" | Double Door Height + 2" | |
| Vertical Lift Motor Operated | | | 24" One Side | | 18" | | |
| Low Headroom Manual | 6 1/2" | 11" | 6" | 9" | Door Height + 30" | Does Not Apply | |
| Low Headroom Motor Operated | 9" | 13 1/2" | | | Door Height + 30" | | |

HEADROOM SELECTION

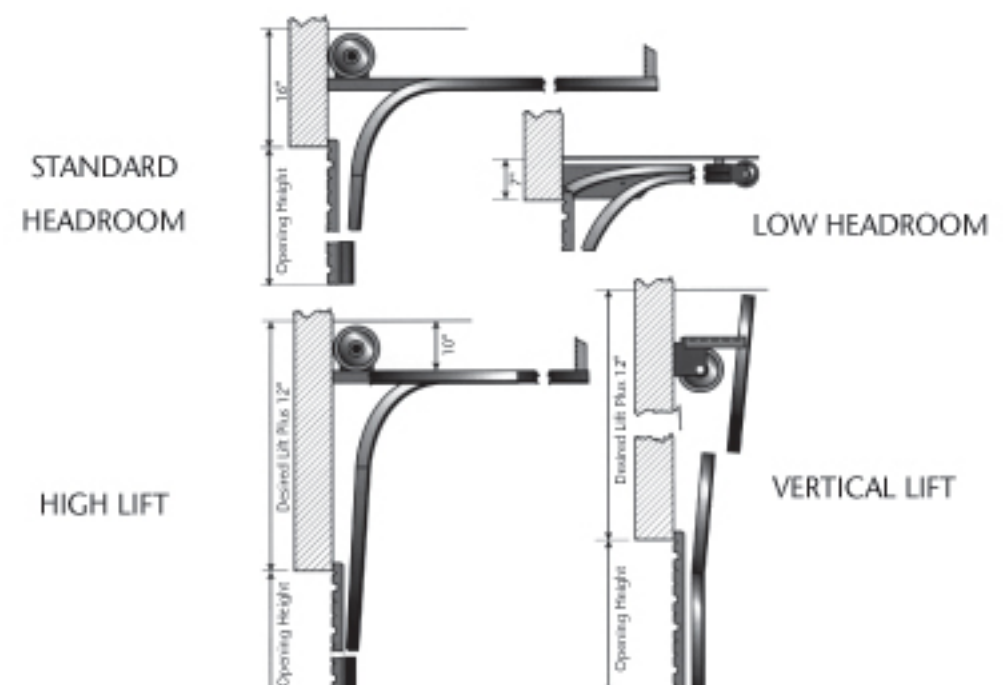

WE DELIVER!

Mid-America Door Company

1001 West Hartford • Ponca City, OK 74601

